



Prepare the short leg

To prepare the short leg:

1. Cut off the short leg below the bushing bracket where it was spot welded at the factory, as shown in Figure 5 below. Grind off any remaining spot welds.
2. Set aside the cut-off section to use during installation.

LC cab model

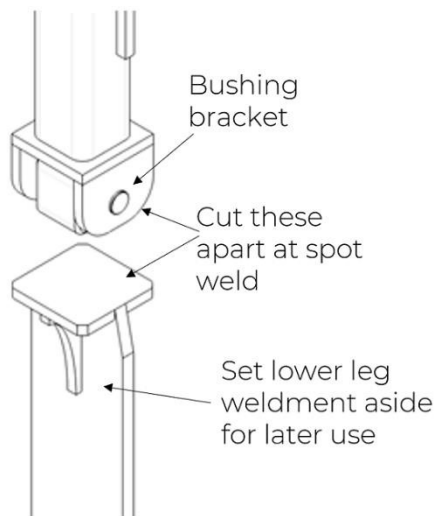

RTS cab model

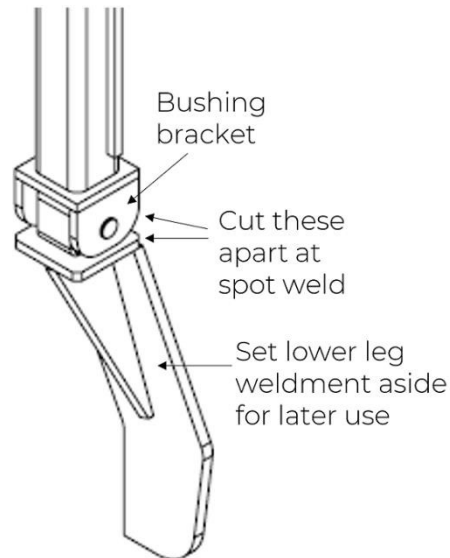

Figure 5: Cut off the short leg below the bushing bracket.



Note: The following three steps apply only to ZX350/350G model excavators.

3. **For ZX350/350G excavator models only:** Cut the bushing bracket off below the upper short leg HSS tubing, where it was tack welded at the factory, as shown in Figure 6 below.

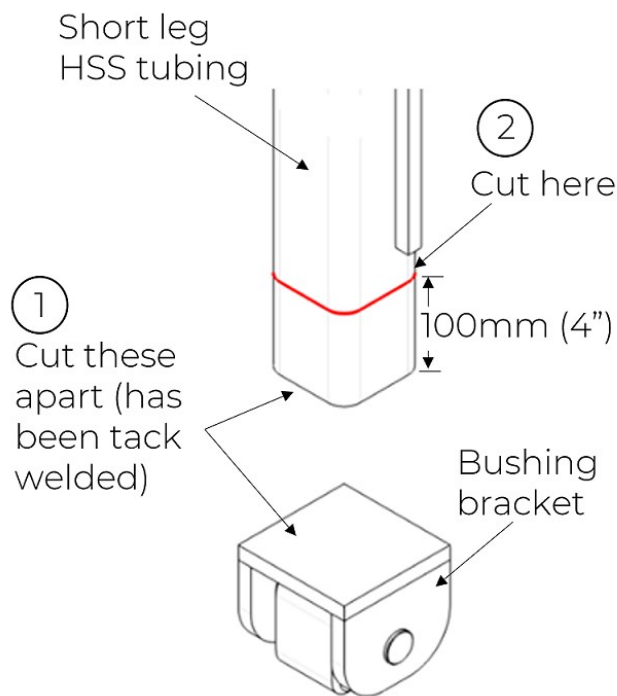

Figure 6: Removing excess short leg HSS tubing (ZX350/350G only)

4. **For ZX350/350G excavator models only:** Cut off the bottom 100mm (4") of the short leg HSS tubing, as shown in Figure 6 above.
5. **For ZX350/350G excavator models only:** Tack weld the bushing bracket back on to the shortened HSS tubing, centre-positioning the bushing bracket.

Note: The remaining steps apply to all models of excavator.

6. Remove the paint and filler material around the area where the short leg HSS tubing is connected to the bushing bracket. Prepare for welding.



7. Weld around the HSS tubing with 6mm (1/4") fillet welds, as shown in Figure 7 below.

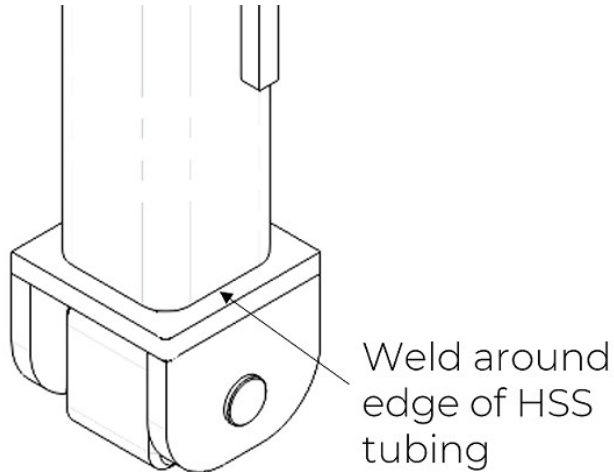

Figure 7: Reattaching bushing bracket to HSS tubing.

Relocate the existing cab door bumpers and replace the door latch

To relocate the existing cab door bumpers and replace the door latch:

1. Remove the existing cab door bumpers and reinstall them as shown in Figure 8 below, keeping the nuts snug tight.

Note: The bumper locations may need to be adjusted during fit-up.